

SNAP'N LOCK BALUSTERS®

Level

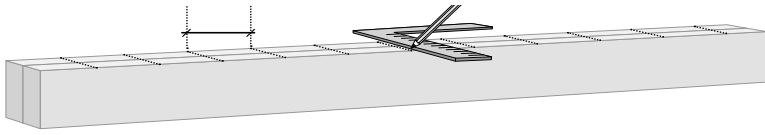

Starting from the center of rails, mark lines at 4-1/2" on center or as required by local codes.

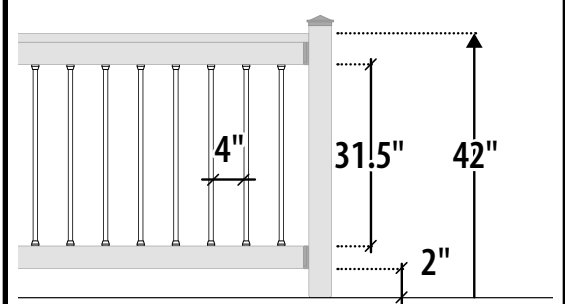
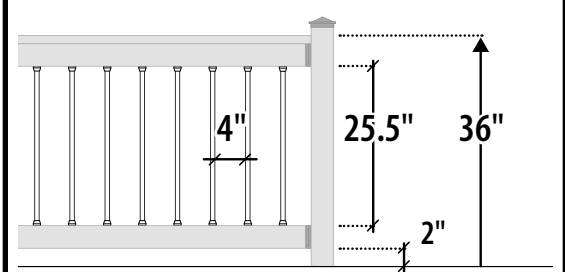

Maximum allowable Gap and space between Balusters is 4."

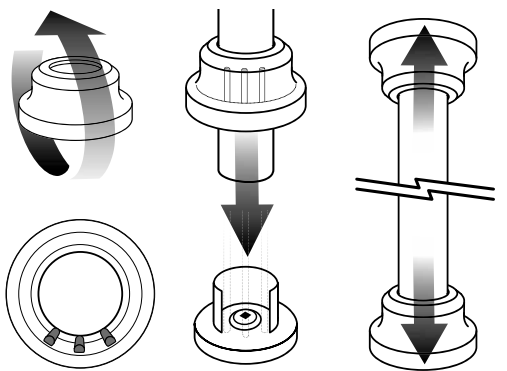

Collars have Inner Male ALIGNMENT COLUMNS

Align COLUMNS with Female opening

SLIDE and PUSH to LOCK Collars with Bases

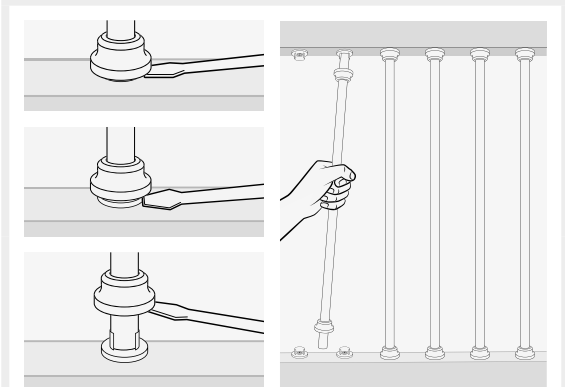

Avoid applying **stain, paint** and **solvents** directly to connectors.

! IMPORTANT !

- Do not use impact driver. Neither the screws or the connectors are designed for installation with an impact driver.
- Use a variable speed screw driver and set torque to low-medium.
- Overdriving screws into the connectors can damage the connector and reduce lifespan.

QUESTIONS? 1-866-577-8868 IN NO EVENT SHALL TITAN BUILDING PRODUCTS BE LIABLE FOR ANY LOSS OR DAMAGE, DIRECT OR OTHERWISE, WHICH RESULTS FROM THE IMPROPER INSTALLATION OR USE OF THIS PRODUCT. IF FOR ANY REASON TITAN BUILDING PRODUCTS BECOMES LIABLE FOR LOSS OR DAMAGE, DIRECT OR OTHERWISE, THE AGGREGATE LIABILITY OF TITAN BUILDING PRODUCTS SHALL BE LIMITED TO THE RETAIL PURCHASE PRICE OF THE PRODUCTS.

PATENT NO

US 11,274,451

GB 2563328

CA 3,001,589



www.titanbp.com/warranty

WARRANTY

Titan Building Products offers a Limited Manufacturer's Warranty. Terms and Conditions Apply.

TITAN BUILDING PRODUCTS®
THE ART OF BUILDING

More Outdoor Beauty... Real easy.



1-866-577-8868

www.titanbp.com

SNAP'N LOCK BALUSTERS® Stair Adapter

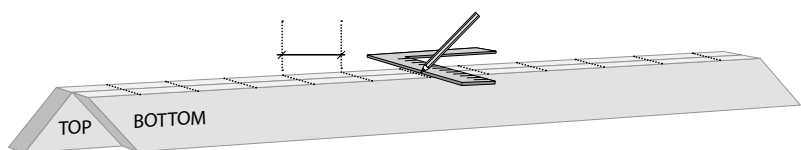

Invert rails as shown. Starting from the center of rails, mark lines at 5 1/2" on center.

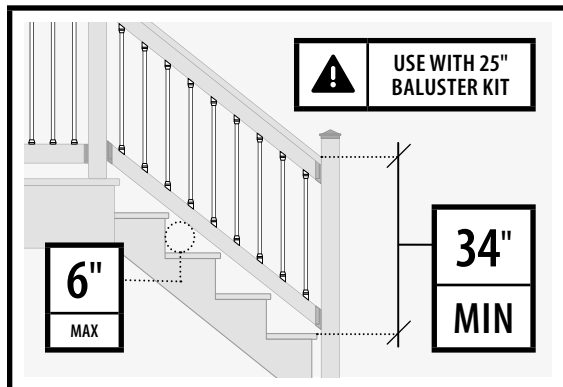

1 Screw

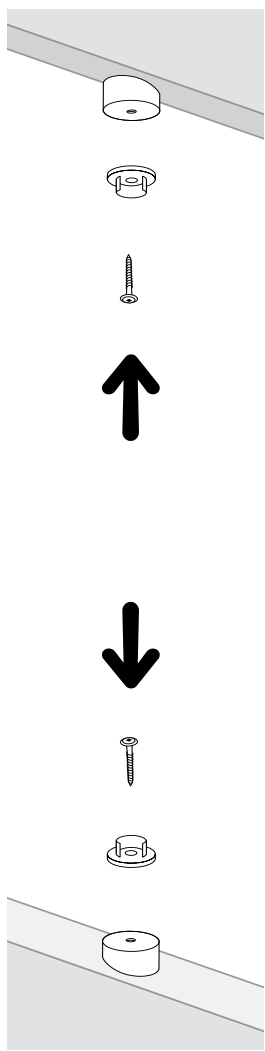

2 Snap

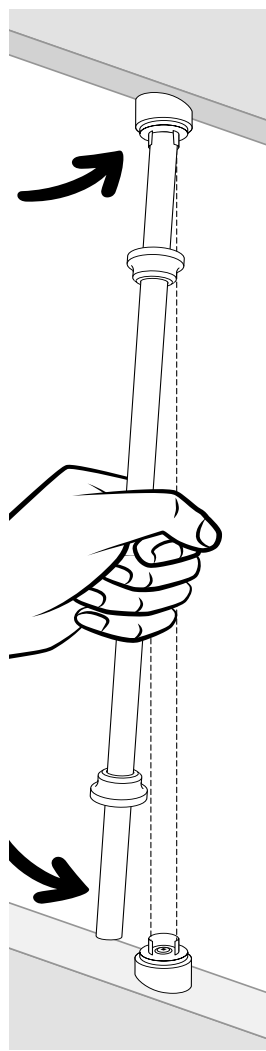

3 Lock

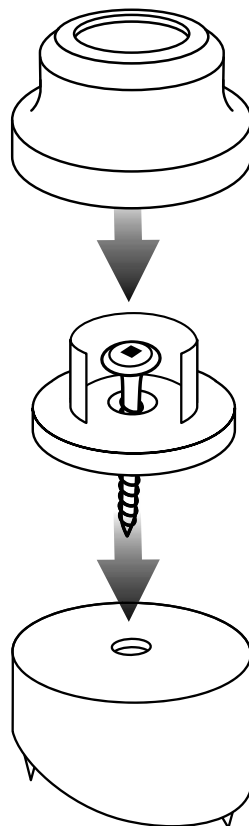
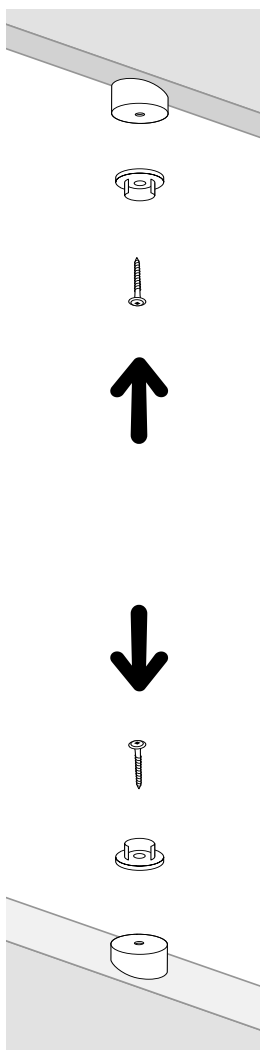

TOP RAIL

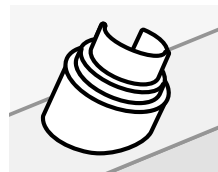
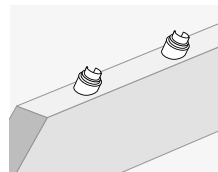

BOTTOM RAIL

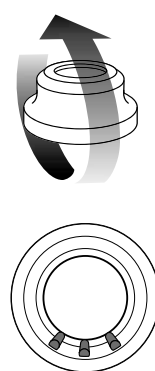
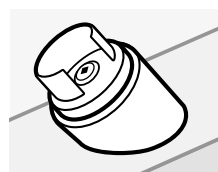
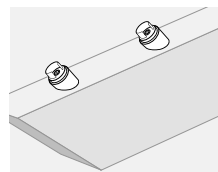

Collars have Inner Male ALIGNMENT COLUMNS

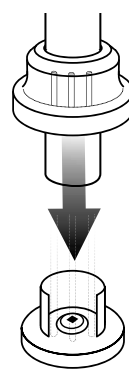

Align COLUMNS with Female opening

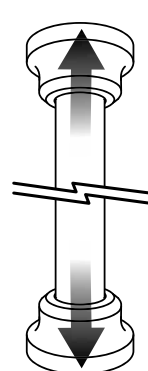

SLIDE and PUSH to LOCK Collars with Bases

! IMPORTANT !

- Do not use impact driver. Neither the screws or the connectors are designed for installation with an impact driver.
- Use a variable speed screw driver and set torque to low-medium.
- Overdriving screws into the connectors can damage the connector and reduce lifespan.

QUESTIONS? 1-866-577-8868 IN NO EVENT SHALL TITAN BUILDING PRODUCTS BE LIABLE FOR ANY LOSS OR DAMAGE, DIRECT OR OTHERWISE, WHICH RESULTS FROM THE IMPROPER INSTALLATION OR USE OF THIS PRODUCT. IF FOR ANY REASON TITAN BUILDING PRODUCTS BECOMES LIABLE FOR LOSS OR DAMAGE, DIRECT OR OTHERWISE, THE AGGREGATE LIABILITY OF TITAN BUILDING PRODUCTS SHALL BE LIMITED TO THE RETAIL PURCHASE PRICE OF THE PRODUCTS.

PATENT NO

US 11,274,451

GB 2563328

CA 3,001,589



www.titanbp.com/warranty

WARRANTY

Titan Building Products offers a Limited Manufacturer's Warranty. Terms and Conditions Apply.

TITAN BUILDING PRODUCTS
THE ART OF BUILDING
More Outdoor Beauty... Real easy.



1-866-577-8868

www.titanbp.com