

# INSTALLATION | COMPRESSION POST BASE 4x4 / 4x6 / 6x6



## IMPORTANT NOTE

FOR COMPRESSION LOADS ONLY WHERE TOP OF POST IS CONNECTED TO AN UPPER STRUCTURE. NOT INTENDED FOR USE IN GUARD RAILS.

### COMPRESSION POST BASE KIT

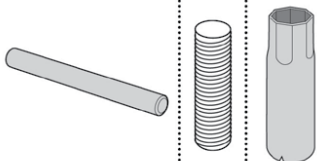
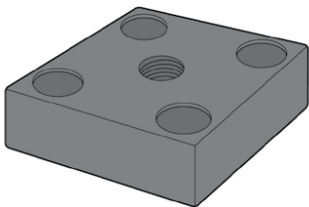

(1) Base, (1) Locking pin,  
(1) Threaded Stud, (1) Tube  
Concrete fasteners sold separately

### TOOLS NEEDED



Hammer

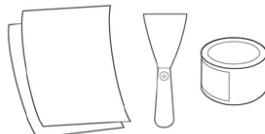

Sandpaper, Putty Knife,  
Wood Filler

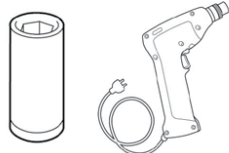

Socket

Drill

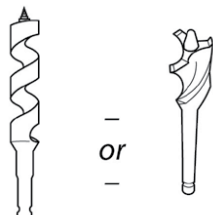

1-1/4"  
Ship Auger

or

1-1/4"  
Speed Bore

### CONCRETE FASTENER

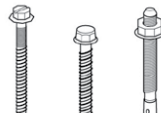

1. 2. 3.

1. Concrete screw
- or -
2. Wedge bolt
- or -
3. Expansion bolt



3/8"  
Speed Bit

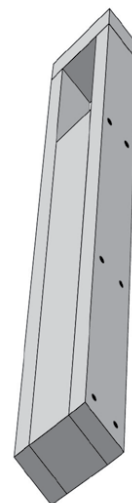

Post Wrench  
See Step 9

CHECK IT OUT!

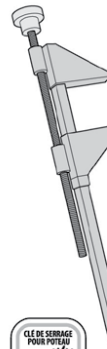

Sold separately

### 1 START

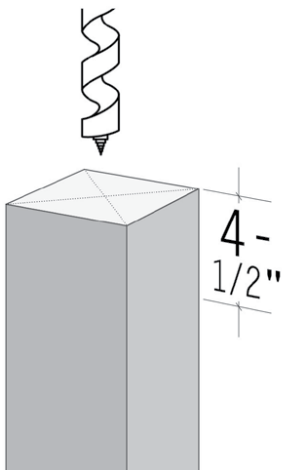

BORE 1-1/4" diameter hole  
to 4-1/4" deep.

### 2

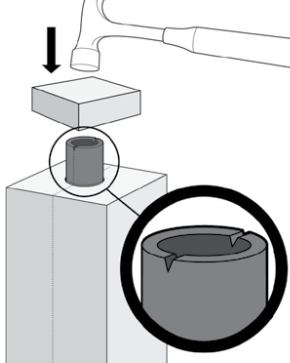

TAP tube  
into bore  
with V-CUT  
facing side  
of post.

### 3A

Tap tube flush with bottom of post.

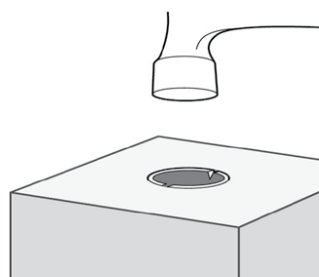

### 3B

Insert threaded stud into nut inside tube.

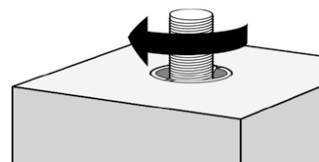

### 3c

Using a scrap of wood, TAP stud to set tube.

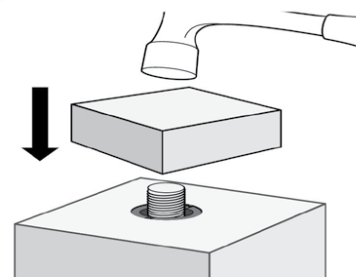

### 3D

1/16" below surface of post.

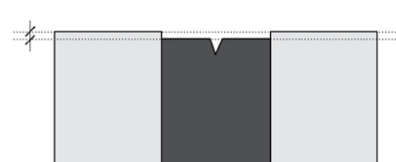

### 4 MARK locking pin hole location in Center of post 3-1/2" from end of post.

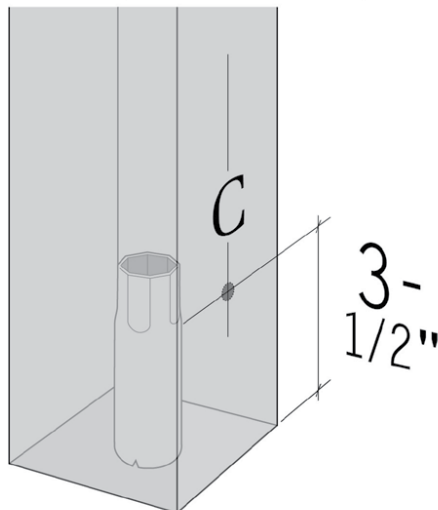

### 5

DRILL with 3/8" speed bit to the opposite side of post.

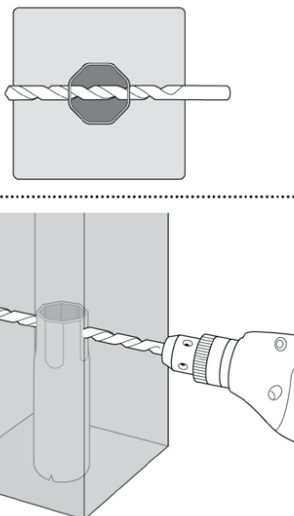

### 6

TAP locking pin into hole and set it 1/8" inside of post.

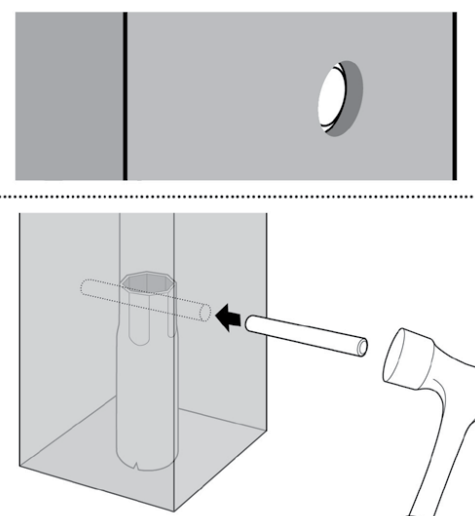

COMPRESSION POST BASE / TICP44 / TICP46 / TICP66

PATENT N<sup>o</sup>

US 9,976,298



www.titanbp.com/warranty

### WARRANTY

Titan Building Products offers a  
Limited Manufacturer's Warranty.  
Terms and Conditions Apply.

**TITAN** BUILDING PRODUCTS  
THE ART OF BUILDING  
More Outdoor Beauty... Real easy.



1-866-577-8868

www.titanbp.com

# INSTALLATION | COMPRESSION POST BASE 4x4 / 4x6 / 6x6



## IMPORTANT NOTE

FOR COMPRESSION LOADS ONLY WHERE TOP OF POST IS CONNECTED TO AN UPPER STRUCTURE. NOT INTENDED FOR USE IN GUARD RAILS.

7

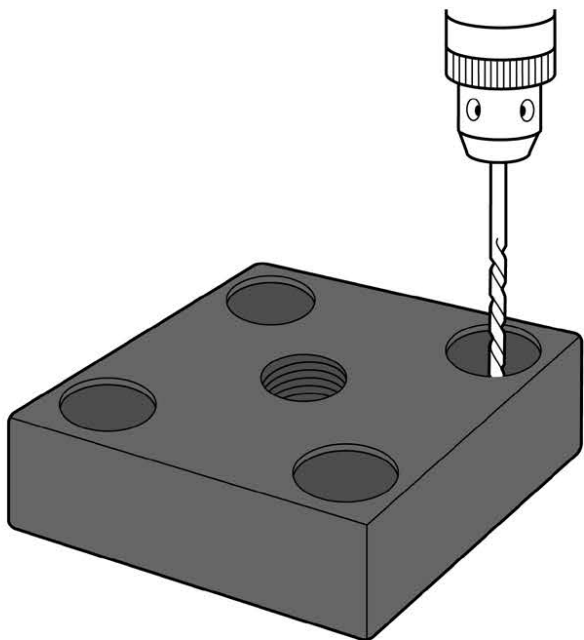

DRILL pilot holes with *masonry bit*.

8

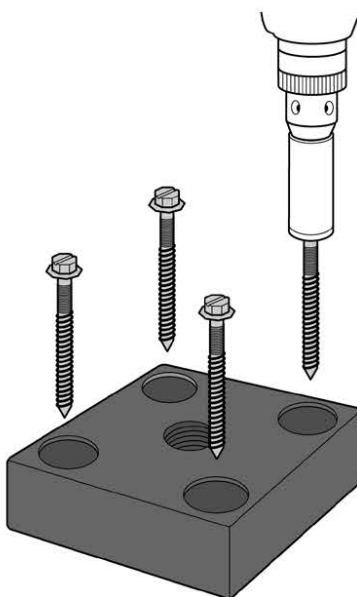

DRIVE fasteners down.

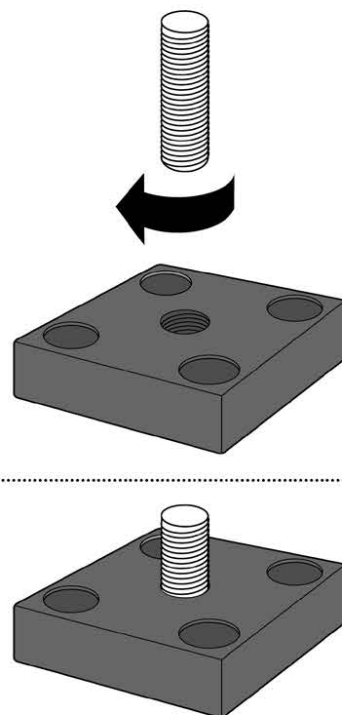

HAND TIGHTEN *threaded stud* until *stud* contacts substrate.

9 Use scrap material and 3-1/2" screws to make *post wrench*.

**CHECK IT OUT!**

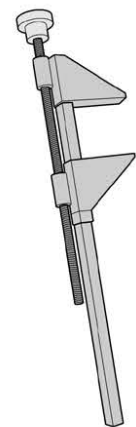
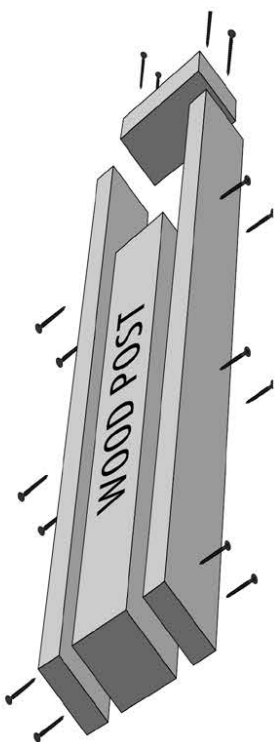

Sold separately

10

HAND TURN *post* on *threaded stud* to base. Once *post* contacts base, use *post wrench* to turn additional 180° maximum.

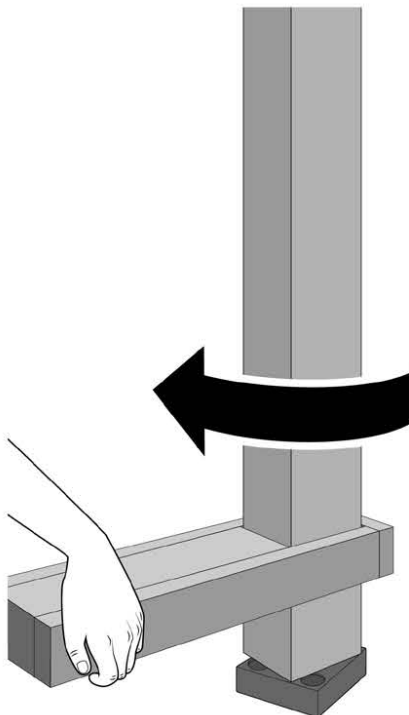

## FINISH

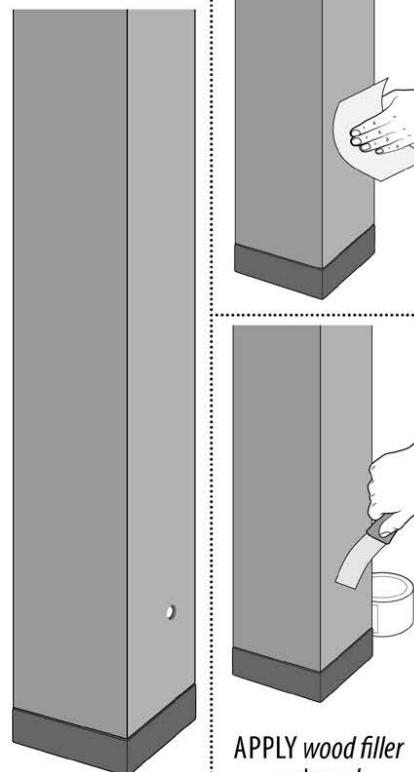

APPLY *wood filler* and *sand*.

IN NO EVENT SHALL TITAN BUILDING PRODUCTS BE LIABLE FOR ANY LOSS OR DAMAGE, DIRECT OR OTHERWISE, WHICH RESULTS FROM THE IMPROPER INSTALLATION OR USE OF THIS PRODUCT. IF FOR ANY REASON TITAN BUILDING PRODUCTS BECOMES LIABLE FOR LOSS OR DAMAGE, DIRECT OR OTHERWISE, THE AGGREGATE LIABILITY OF TITAN BUILDING PRODUCTS SHALL BE LIMITED TO THE RETAIL PURCHASE PRICE OF THE PRODUCTS.

COMPRESSION POST BASE / TICP44 / TICP46 / TICP66

PATENT NO

US 9,976,298



[www.titanbp.com/warranty](http://www.titanbp.com/warranty)

### WARRANTY

Titan Building Products offers a Limited Manufacturer's Warranty. Terms and Conditions Apply.

**TITAN** BUILDING PRODUCTS®  
THE ART OF BUILDING  
More Outdoor Beauty... Real easy.



1-866-577-8868

[www.titanbp.com](http://www.titanbp.com)