

# Hand Auger Tool Instructions

(1) Drill 3/4" dia. x 3/4" deep hole in center of 24" or longer 2x4.

1

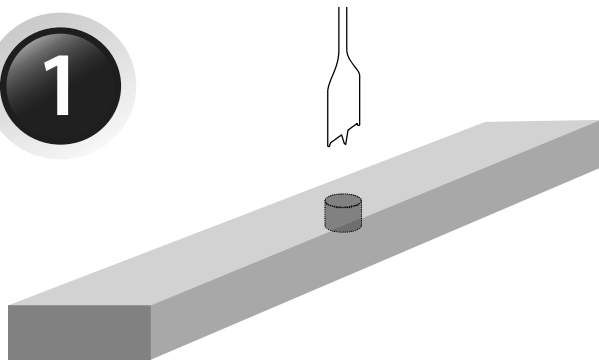

(2) Fasten the Auger Tool to the 2x4 with 2 Panhead screws.

2

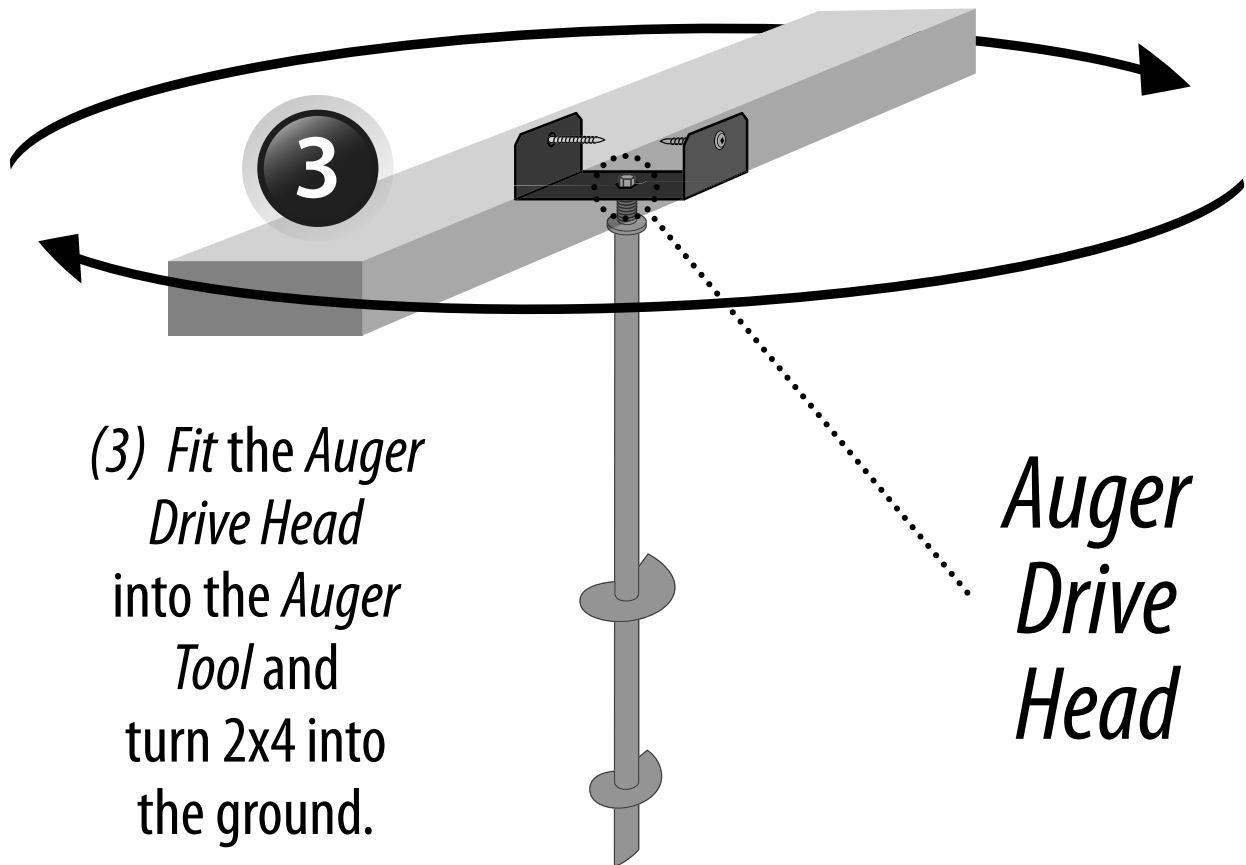
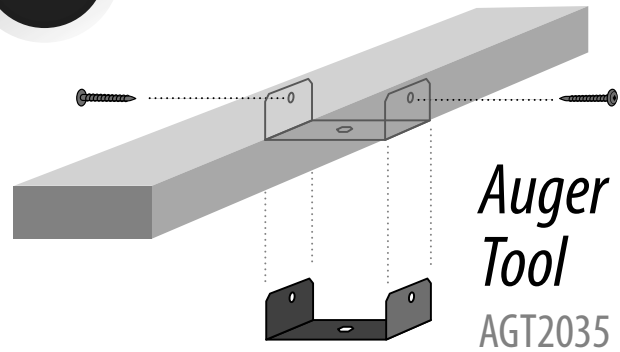

(3) Fit the Auger Drive Head into the Auger Tool and turn 2x4 into the ground.

Auger Drive Head

[www.titanbp.com](http://www.titanbp.com)

**TITAN** BUILDING PRODUCTS®  
THE ART OF BUILDING